



**COMPUTER UNIT TITLE REGISTER
UNDER LAND TRANSFER ACT 1952**



**Guaranteed Search Copy issued under Section 172A
of the Land Transfer Act 1952**

R. W. Muir
Registrar-General
of Land

Identifier NA133A/429
Land Registration District North Auckland
Date Issued 07 November 2000

Prior References
NA133A/350

Supplementary Record Sheet
NA133A/446

Estate Stratum in Freehold
Legal Description Unit 5A and Accessory Unit 1 and 133
Deposited Plan 204464

Proprietors
MDF Investments Limited

The above estates are subject to the reservations, restrictions, encumbrances, liens and interests noted below and on the relevant unit plan and supplementary record sheet

D555480.9 Consent Notice pursuant to Section 221(1) Resource Management Act 1991 - 7.11.2000 at 12.41 pm

8976931.1 Compensation Certificate pursuant to Section 19 Public Works Act 1981 by Auckland Council - 7.2.2012 at 11:05 am

9031141.3 Mortgage to Bank of New Zealand - 4.4.2012 at 3:32 pm

Identifier

NA133A/429



**SUPPLEMENTARY RECORD SHEET
UNDER UNIT TITLES ACT 1972**

**Guaranteed Search Copy issued under Section 172A
of the Land Transfer Act 1952**

Identifier

NA133A/446

Land Registration District

North Auckland

Date Issued

07 November 2000

Plan Number

DP 204464

Subdivision of

Lot 2 Deposited Plan 204463

Prior References

NA133A/350

Unit Titles Issued

153196	153197	NA133A/353	NA133A/354
NA133A/355	NA133A/356	NA133A/357	NA133A/358
NA133A/359	NA133A/360	NA133A/361	NA133A/362
NA133A/363	NA133A/364	NA133A/365	NA133A/366
NA133A/367	NA133A/368	NA133A/369	NA133A/370
NA133A/371	NA133A/372	NA133A/373	NA133A/375
NA133A/376	NA133A/377	NA133A/378	NA133A/379
NA133A/380	NA133A/381	NA133A/382	NA133A/383
NA133A/384	NA133A/385	NA133A/386	NA133A/387
NA133A/388	NA133A/389	NA133A/390	NA133A/391
NA133A/392	NA133A/393	NA133A/394	NA133A/395
NA133A/396	NA133A/397	NA133A/398	NA133A/399
NA133A/400	NA133A/401	NA133A/402	NA133A/403
NA133A/404	NA133A/407	NA133A/408	NA133A/409
NA133A/411	NA133A/412	NA133A/413	NA133A/414
NA133A/415	NA133A/416	NA133A/417	NA133A/418
NA133A/419	NA133A/420	NA133A/421	NA133A/422
NA133A/423	NA133A/424	NA133A/425	NA133A/426
NA133A/427	NA133A/428	NA133A/429	NA133A/430
NA133A/431	NA133A/432	NA133A/433	NA133A/434
NA133A/435	NA133A/436	NA133A/437	NA133A/438
NA133A/439	NA133A/440	NA133A/441	NA133A/442
NA133A/443	NA133A/444	NA133A/445	NA133C/937
NA133C/938			

Interests

Identifier**NA133A/429****OWNERSHIP OF COMMON PROPERTY**

Pursuant to Section 47 Unit Titles Act 2010 -

(a) the body corporate owns the common property and

(b) the owners of all the units are beneficially entitled to the common property as tenants in common in shares proportional to the ownership interest (or proposed ownership interest) in respect of their respective units.

The above memorial has been added to Supplementary Record Sheets issued under the Unit Titles Act 1972 to give effect to Section 47 of the Unit Titles Act 2010.

Appurtenant hereto is a drainage right created by Transfer 672009 - 6.12.1961 at 12:13 pm

Subject to a drainage right (in gross) over part marked N, T, P and R on DP 204463 in favour of The Waitakere City Council created by Transfer D286836.7 - 30.6.1998 at 12.20 pm

The easements created by Transfer D286836.7 are subject to Section 243 (a) Resource Management Act 1991

Subject to a water supply right (in gross) over part marked H, D, K, N and T on DP 204463 in favour of The Waitakere City Council created by Transfer D286836.5 - 30.6.1998 at 12.20 pm

The easements created by Transfer D286836.5 are subject to Section 243 (a) Resource Management Act 1991

Subject to an electricity right (in gross) over parts marked H, D, K, N and T on DP 204463 in favour of The Waitemata Electric Power Board created by Transfer B878713.1 - 22.8.1998 at 2.12 pm

Subject to a drainage right over parts marked I, E, Q, W P and R on DP 204463 specified in Easement Certificate B878713.4 - 22.8.1998 at 2.12 pm

D555480.2 Consent Notice pursuant to Section 221(1) Resource Management Act 1991 (DP 204463) - 7.11.2000 at 12.41 pm

Subject to a drainage right (in gross) over part marked S, G, N, T, P, R, W, I, H, E, D, Q and k on DP 204463 in favour of The Waitakere City Council created by Transfer D555480.5 - 7.11.2000 at 12.41 pm

The easements created by Transfer D555480.5 are subject to Section 243 (a) Resource Management Act 1991

Subject to a right of way over parts marked G, W and R and a recreation use right over parts marked A and B on DP 204463 specified in Easement Certificate D555480.6 - 7.11.2000 at 12.41 pm

The easements specified in Easement Certificate D555480.6 are subject to Section 243 (a) Resource Management Act 1991

D555480.9 Consent Notice pursuant to Section 221(1) Resource Management Act 1991 (DP 204464)- 7.11.2000 at 12.41 pm

D568184.1 Change of rules of the Body Corporate - 20.12.2000 at 1.41 pm

D666177.2 Change of rules of the Body Corporate - 14.12.2001 at 12.40 pm

9229267.1 Notice of change of body corporate operational rules pursuant to Section 106 Unit Titles Act 2010 - 6.11.2012 at 12:38 pm

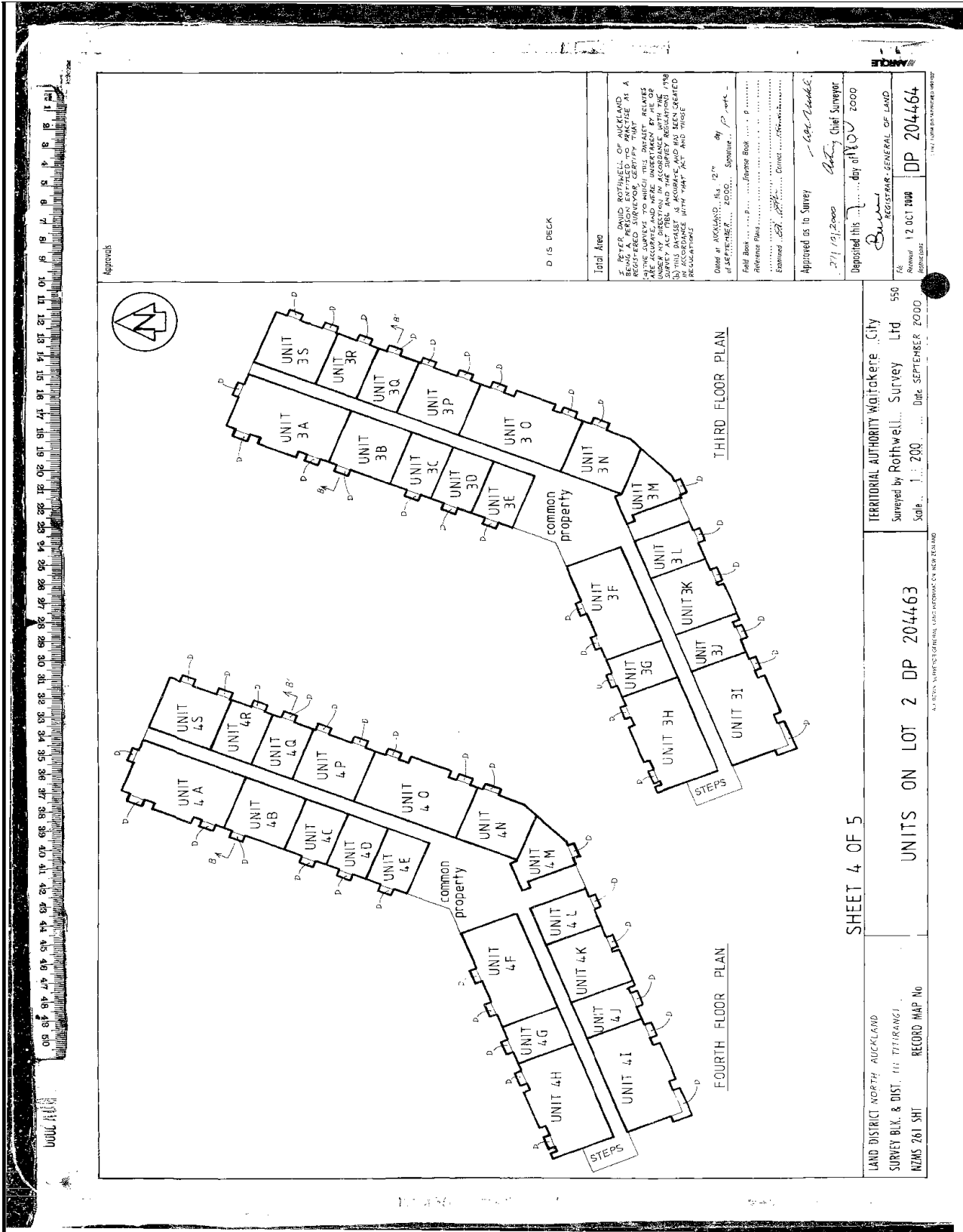

Approvals

D/S DECK

Total Area

IF BYER DAVID ROTHWELL OF AUCKLAND BEING A PERSON ENTITLED TO PRATISE AS A REGISTERED SURVEYOR AND HIS SURVEY BEING ACCURATE AND MADE UNDERMAY BY ME OF THE SURVEY ACT 1988 AND THE SURVEY REGULATIONS 1988 AND THIS SURVEY BEING MADE IN ACCORDANCE WITH THE ACT AND THESE REGULATIONS

UNIT 4 AUCKLAND, N.S. 127th SEPT. 2000

Field Book

Reference Plans

Examined

Approved as to Survey

27/11/2000

Deposited this

2000

REGISTRAR - GENERAL OF LAND

DP 204464

12 OCT 2000

SHEET 4 OF 5

LAND DISTRICT NORTH AUCKLAND

SURVEY BLK. & DIST. III THIRANGI

RZMS 761 SH1

RECORD MAP No.

UNITS ON LOT 2 DP 204463

TERRITORIAL AUTHORITY Waikare City

Surveyed by Rothwell, Survey Ltd

Scale 1:200 Date SEPTEMBER 2000

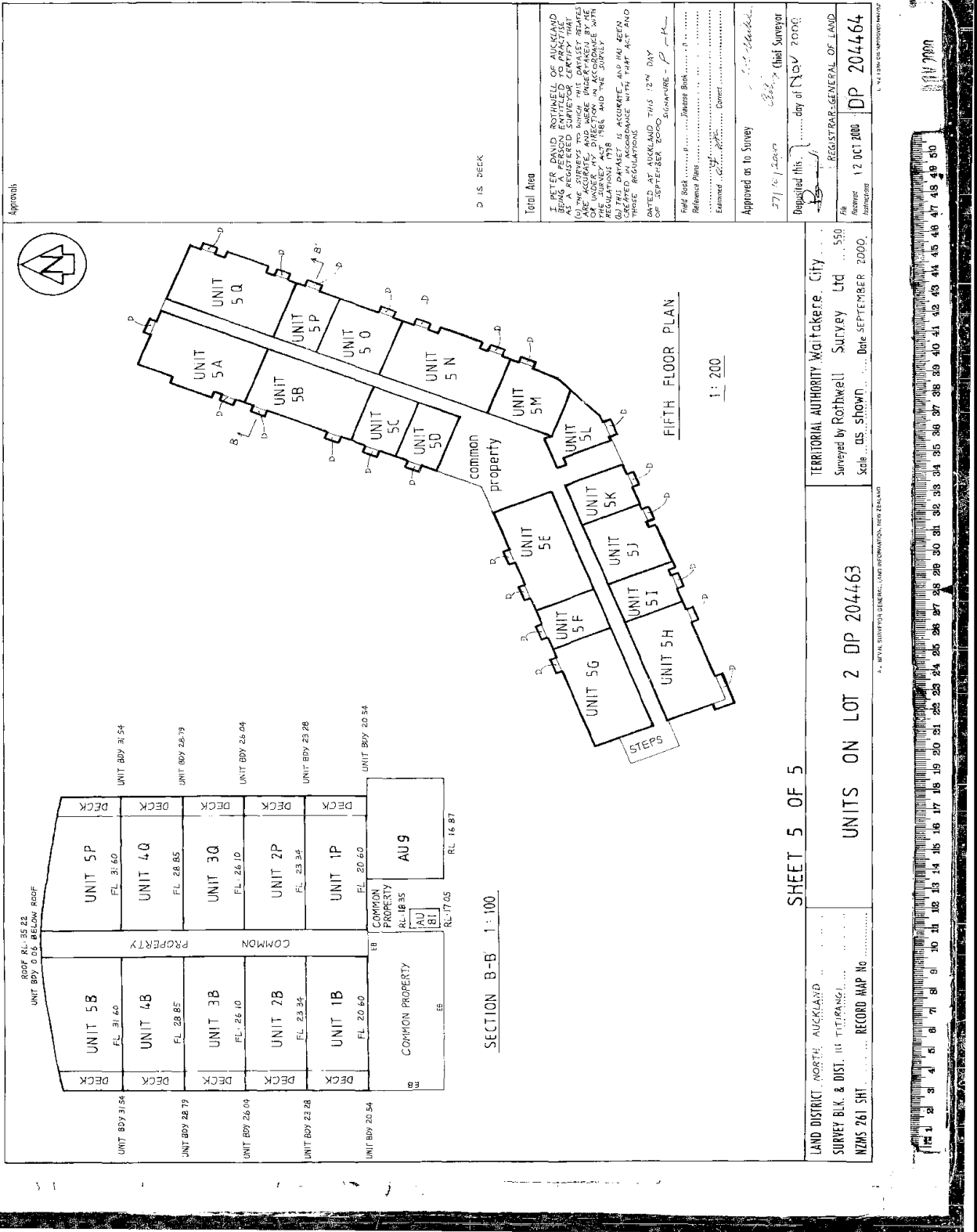

Approvals

D IS DECK

Total Area

I, PETER DAVID ROTHWELL OF AUCKLAND
 AS A REGISTERED SURVEYOR CERTIFY THAT
 (A) THE SURVEY TO WHICH THIS DATASET RELATES
 WAS MADE IN ACCORDANCE WITH THE
 SURVEY ACT 1986 AND THE SURVEY
 REGULATIONS 1986, AND THE SURVEY
 PLAN IS ACCURATE AND TRUE TO THE
 ORIGINAL FIELD DATA AND HAS BEEN
 CHECKED IN ACCORDANCE WITH THAT ACT AND
 THE REGULATIONS.
 I HEREBY CERTIFY THAT THIS DATASET
 WAS MADE IN ACCORDANCE WITH THAT ACT AND
 THE REGULATIONS.
 DATE 12 SEPTEMBER 2000
 SIGNATURE - P. Rothwell

Examined by: [Signature] Correct

Approved as to Survey: [Signature] Chief Surveyor

Deposited this 12th day of NOV 2000

REGISTRAR-GENERAL OF LAND
 RECEIVED 12 OCT 2000 DP 204464

SHEET 5 OF 5

TERRITORIAL AUTHORITY Waitakere City
 Surveyed by Rothwell Survey Ltd ... 550
 Scale as shown Date SEPTEMBER 2000

UNITS ON LOT 2 DP 204464

LAND DISTRICT NORTH AUCKLAND
 SURVEY BLK. & DIST. 113 TITIRANGI
 RECORD MAP No



REGISTERED SURVEYOR GENERAL LAND INFORMATION, NEW ZEALAND