



**COMPOSITE COMPUTER REGISTER
UNDER LAND TRANSFER ACT 1952**



**Guaranteed Search Copy issued under Section 172A
of the Land Transfer Act 1952**

R. W. Muir
Registrar-General
of Land

Identifier **NA40B/1064**
Land Registration District **North Auckland**
Date Issued 04 August 1977

Prior References

NA26B/890

Estate Fee Simple - 1/8 share
Area 1628 square metres more or less
Legal Description Lot 1-2 Deposited Plan 49357

Proprietors

Dorothy Venus Leggett

Estate	Leasehold	Instrument	L 543752.8
		Term	999 years as from and including 1st August 1977

Legal Description Flat 8 Deposited Plan 84138

Proprietors

Dorothy Venus Leggett

Interests

- 543752.1 Lease of Flat 1 Composite CT NA40B/1057 issued - 4.8.1977 (Affects Fee Simple)
- 543752.2 Lease of Flat 2 Composite CT NA40B/1058 issued - 4.8.1977 (Affects Fee Simple)
- 543752.3 Lease of Flat 3 Composite CT NA40B/1059 issued - 4.8.1977 (Affects Fee Simple)
- 543752.7 Lease of Flat 7 Composite CT NA40B/1063 issued - 4.8.1977 (Affects Fee Simple)
- 543752.8 Lease of Flat 8 DP 84138 Term 999 years as from and including 1st August 1977 Composite CT NA40B/1064 issued - 4.8.1977 (Affects Fee Simple)
- 543752.4 Lease of Flat 4 Composite CT NA40B/1060 issued - 4.8.1977 (Affects Fee Simple)
- 543752.5 Lease of Flat 5 Composite CT NA40B/1061 issued - 4.8.1977 (Affects Fee Simple)
- 543752.6 Lease of Flat 6 Composite CT NA40B/1062 issued - 4.8.1977 (Affects Fee Simple)
- D637750.3 Mortgage to ANZ Banking Group (New Zealand) Limited - 6.9.2001 at 9.00 am

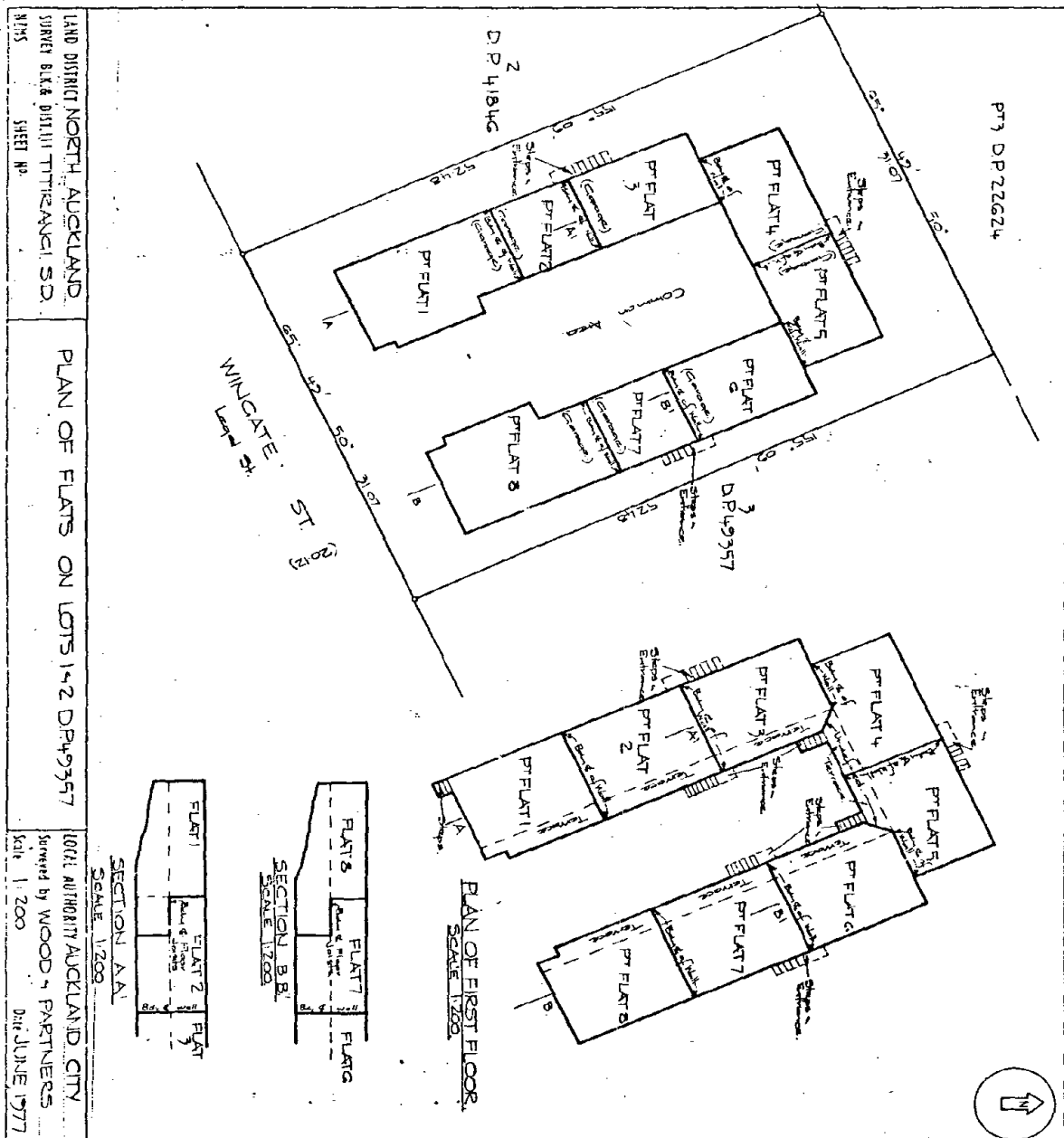

LAND DISTRICT NORTH AUCKLAND
 SURVEY B/LK 011/111 TITIRANGI S.D.
 SHEET NO. 11/15

PLAN OF FLATS ON LOTS 1-2 DRP49357

LOCAL AUTHORITY AUCKLAND CITY
 SURVEYED BY WOOD & PARTNERS
 DATE 1 JUNE 1977

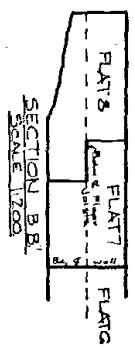
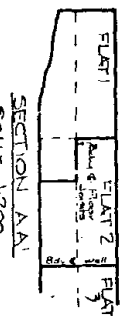

PLAN OF FIRST FLOOR
 SCALE 1:200

<p>Responsible of Registration</p>																	
<p>NEW C.S.T. ALLOCATED:</p> <table border="1"> <tr><td>FLAT 1</td><td>40 B - 1057</td></tr> <tr><td>FLAT 2</td><td>40 B - 1058</td></tr> <tr><td>FLAT 3</td><td>40 B - 1059</td></tr> <tr><td>FLAT 4</td><td>40 B - 1060</td></tr> <tr><td>FLAT 5</td><td>40 B - 1061</td></tr> <tr><td>FLAT 6</td><td>40 B - 1062</td></tr> <tr><td>FLAT 7</td><td>40 B - 1063</td></tr> <tr><td>FLAT 8</td><td>40 B - 1064</td></tr> </table>		FLAT 1	40 B - 1057	FLAT 2	40 B - 1058	FLAT 3	40 B - 1059	FLAT 4	40 B - 1060	FLAT 5	40 B - 1061	FLAT 6	40 B - 1062	FLAT 7	40 B - 1063	FLAT 8	40 B - 1064
FLAT 1	40 B - 1057																
FLAT 2	40 B - 1058																
FLAT 3	40 B - 1059																
FLAT 4	40 B - 1060																
FLAT 5	40 B - 1061																
FLAT 6	40 B - 1062																
FLAT 7	40 B - 1063																
FLAT 8	40 B - 1064																
<p>Boundaries of areas to be lowered are shown by dotted lines of structures under division shown</p>																	
<p>Total Area 1620 m² Computed in C.T. 200/2000</p>																	
<p>Approved by the Surveyor General on the 19th day of June 1977 Approved by the Registrar on the 19th day of June 1977</p>																	
<p>Approved as to Survey by the Registrar on the 19th day of June 1977</p>																	
<p>Approved as to Survey by the Registrar on the 19th day of June 1977</p>																	
<p>Approved as to Survey by the Registrar on the 19th day of June 1977</p>																	