



**RECORD OF TITLE  
UNDER LAND TRANSFER ACT 2017  
LEASEHOLD**

**Guaranteed Search Copy issued under Section 60 of the Land  
Transfer Act 2017**



  
R. W. Muir  
Registrar-General  
of Land

**Identifier** NA6B/146  
**Land Registration District** North Auckland  
**Date Registered** 08 July 1965 12:00 am

**Prior References**  
NA1341/29

---

<b>Estate</b>	Leasehold	<b>Instrument</b>	L A88522
		<b>Term</b>	999 years as from and including 7.7.1965

**Legal Description** Flat 1 Deposited Plan 55300 and Garage 1  
Deposited Plan 55300

**Registered Owners**  
Myrtle Kathleen Conway

---

**Interests**

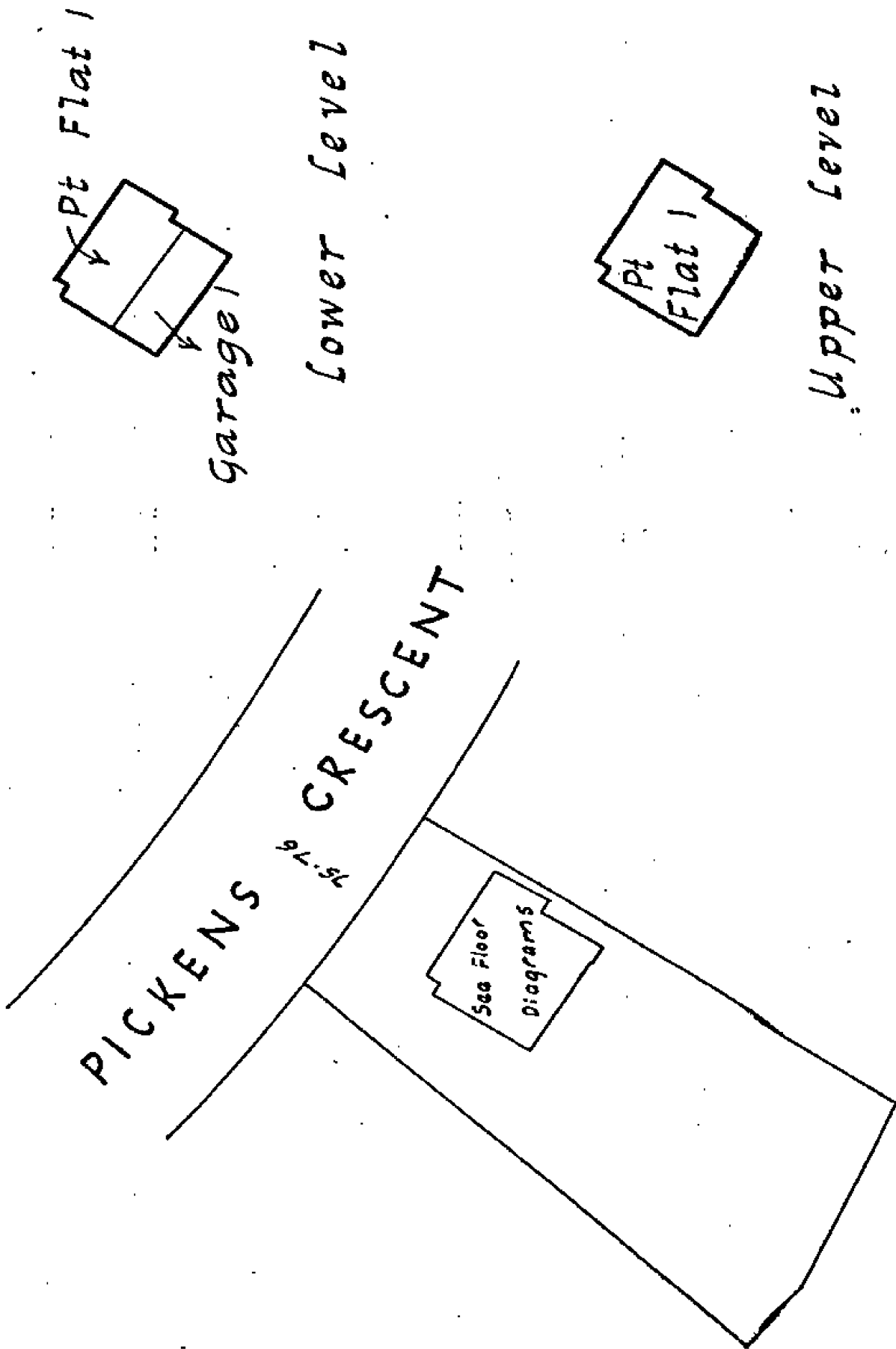



**RECORD OF TITLE  
UNDER LAND TRANSFER ACT 2017  
FREEHOLD**

**Guaranteed Search Copy issued under Section 60 of the Land  
Transfer Act 2017**



  
R. W. Muir  
Registrar-General  
of Land

**Identifier** **NA9B/1314**  
**Land Registration District** **North Auckland**  
**Date Issued** 07 October 1966

**Prior References**

NA1341/29

---

**Estate** Fee Simple - 1/3 share  
**Area** 766 square metres more or less  
**Legal Description** Lot 17 Deposited Plan 42266

**Registered Owners**

Myrtle Kathleen Conway

---

**Interests**

A88524 Lease of Flat 3 and Garage 3 Plan 35300 CT NA6B/148 issued  
A88523 Lease of Flat 2 and Garage 2 Plan 35300 CT NA6B/147 issued  
Appurtenant hereto is a right of way created by Transfer 338902  
12288 Order in Council imposing Building Line Restriction  
A88522 Lease of Flat 1 and Garage 1 Plan 35300 CT NA6B/146 issued

775

Image Quality due to Condition of Original

Scale: 1 inch = 2 chains

Pickens Cres

Pickens Cres.

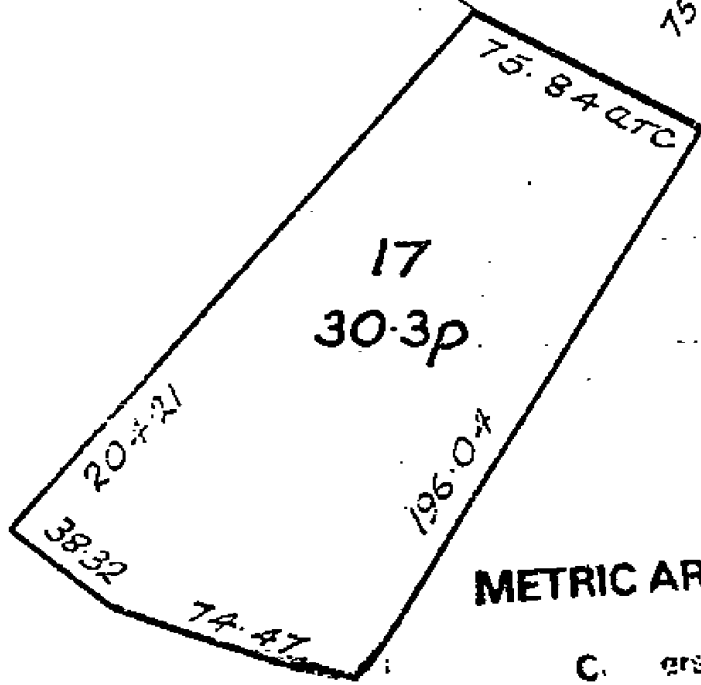

METRIC AREA IS 466  
766m<sup>2</sup>  
Conversion Factors:

